

Mod. Css

Trailer with polyethylene foam tank

Standard characteristics

Trailer material: Carbon steel

Tank material: Plastic/Polyethylene

Typology: Single-axle trailer

Tank capacity: 120 l

Portable foam branchpipe: Mod. LM
Mod. MEP
(See dedicated pages)

Line self-inductor: Mod MS (See dedicated page)

Hose boxes (For hoses, see dedicated page)

Pneumatic tires

Coating: Epoxy Primer + Polyuretanic red coat RAL3000,
Total DFT >120 µm

Empty weight: ~90 Kg

Approvals



Notes

In case of inquiry and/or order specify the following datas:

- > Flow rate and pressure of foam branchpipe, LM or MEP foam branchpipe type, 3/6% mixing percentage
- of MS line self-inductor, hose lenght

Optional

- > Different type of low and medium foam branchpipes

Available on Demand

- > Hot dip galvanized trailer frame
- > Tires: Solid
- > Coating: Other painting cycles

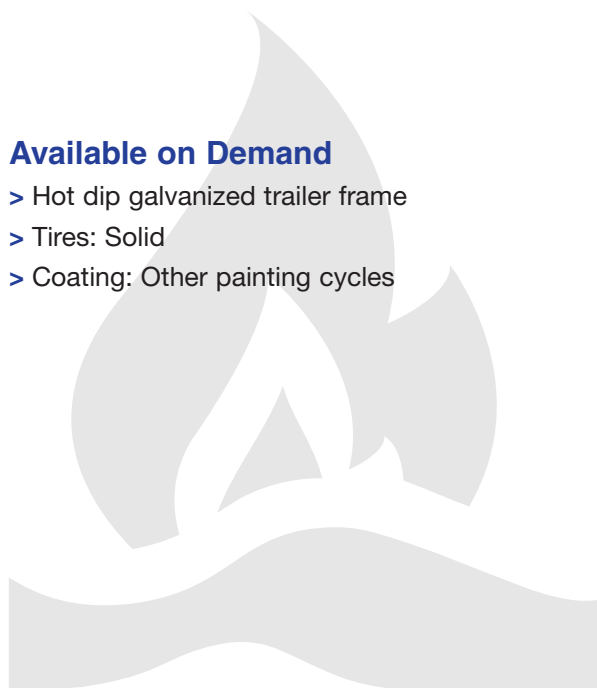

www.fasspa.net

Mod. Css

Trailer with polyethylene foam tank

Layout & Overall Dimension

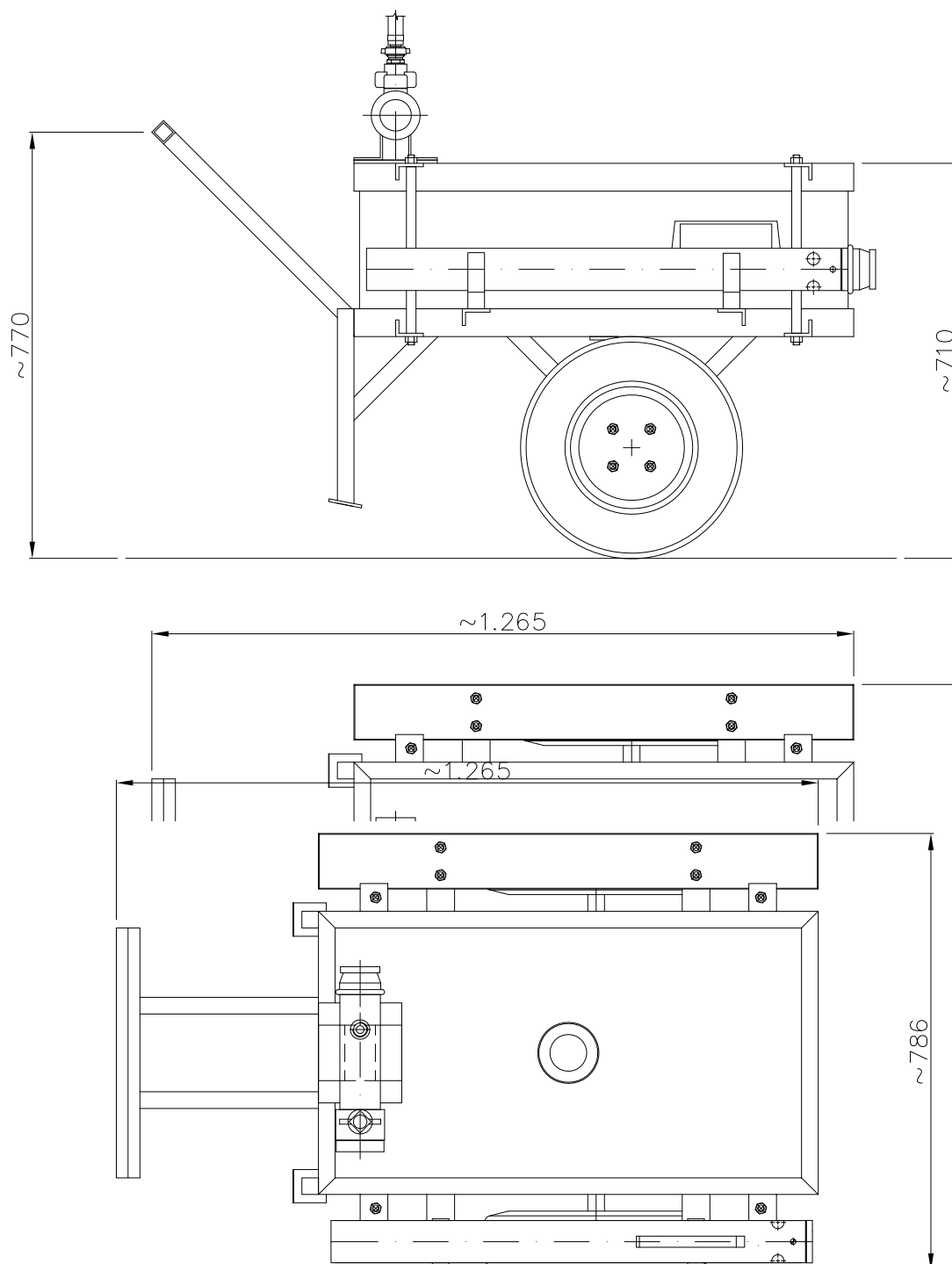

www.fasspa.net



OUR EQUIPMENT ARE DESIGNED,
PRODUCED AND TESTED IN FAS S.p.A. - ITALY

In order to improve their efficiency, FAS may modify characteristics and dimensions of its own products without prior notice.