

Mod. MF

Fixed flow rate foam inductor with pipe for in-line connection

Standard characteristics

Body size: 1" - 1 1/2" - 2"

Flow rate: From 100 to 300 l/1'

Body material: Stainless steel

Strainer and check valve material: Brass

Nozzle: Stainless steel

Pipe for in-line connection made in carbon steel: From 3" to 8"

Connection type: Flanged on request

Coating: Epoxy Primer + Polyurethane red coat RAL3000,
Total DFT >120 µm

Weight (only for foam inductor): MF-1: ~20 Kg
MF-2: ~30 Kg
MF-3: ~40 Kg

Approvals

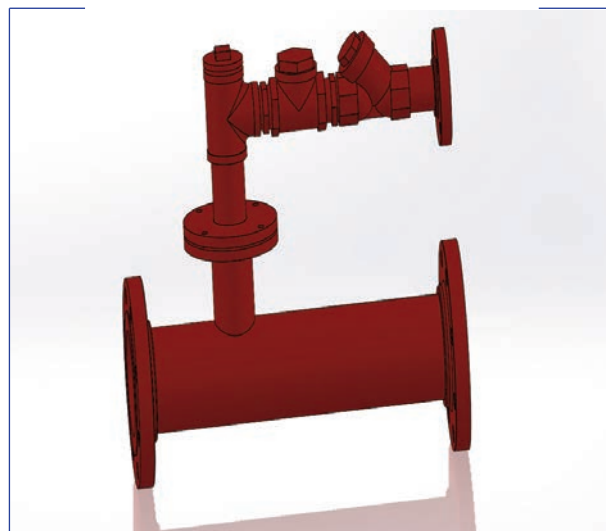

Notes

In case of inquiry and/or order specify the following datas:

> Flow rate, Operating pressure, Connection Type

Available on Demand

> Threaded inlet

> Coating: Other painting cycles



www.fasspa.net

Mod. MF

Fixed flow rate foam inductor with pipe for in-line connection

Layout & Overall Dimension

