



Mod. VP

Foam test valve to test the foam discharge in fixed tanks protection system

Standard characteristics

Body material: "Anticorodal" light alloy

Connection type std F.A.S. (Carbon steel flanges):

VP-3: Flanged 3"

VP-4: Flanged 4"

VP-6: Flanged 6"

Test outlet connection: UNI 70 M with cap and chain

Carbon steel lever, with handwheel with knob blocking device

Coating: Epoxy Primer + Polyuretanic red coat RAL3000,
Total DFT >120 µm

Weight: VP-3: ~13 Kg

VP-4: ~15 Kg

VP-6: ~20 Kg

Approvals

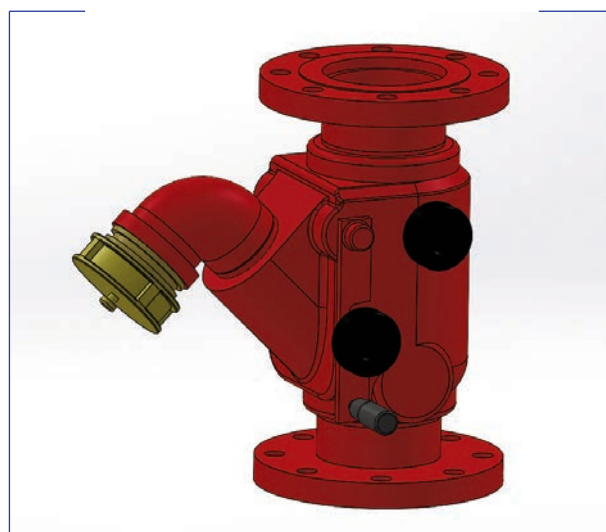

Notes

In case of inquiry and/or order specify the following datas:

> Inlet and outlet flanges type and diameter

Available on Demand

> Connection flanges, and test outlet connection different from standard

> Coating: Other painting cycles

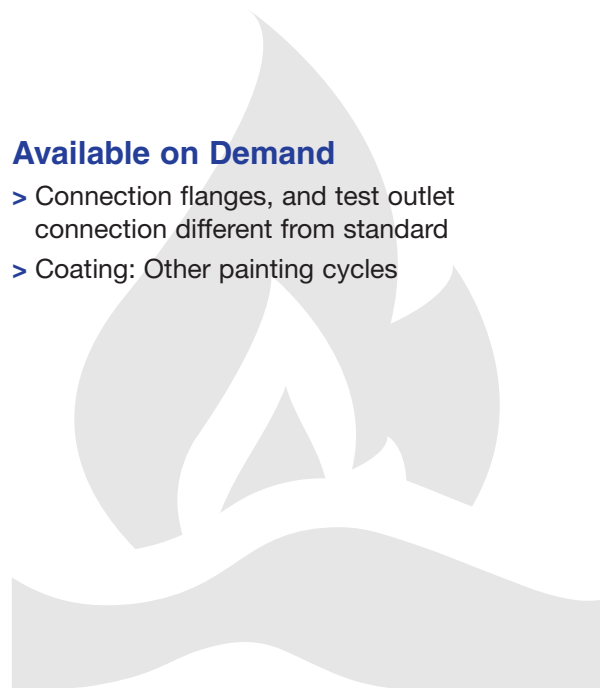

www.fasspa.net

Mod. VP

Foam test valve to test the foam discharge in fixed tanks protection system

Layout & Overall Dimension

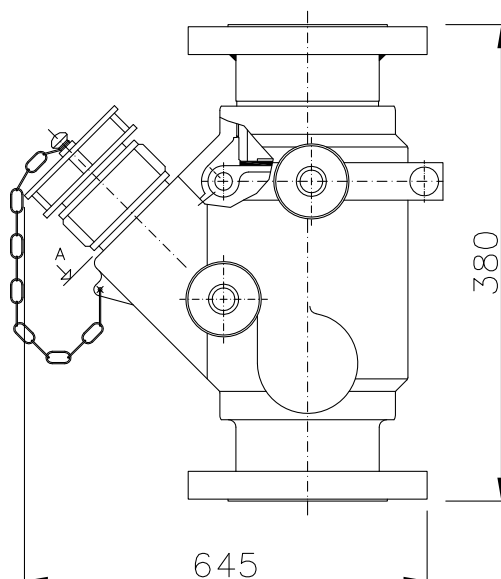

Typical Application

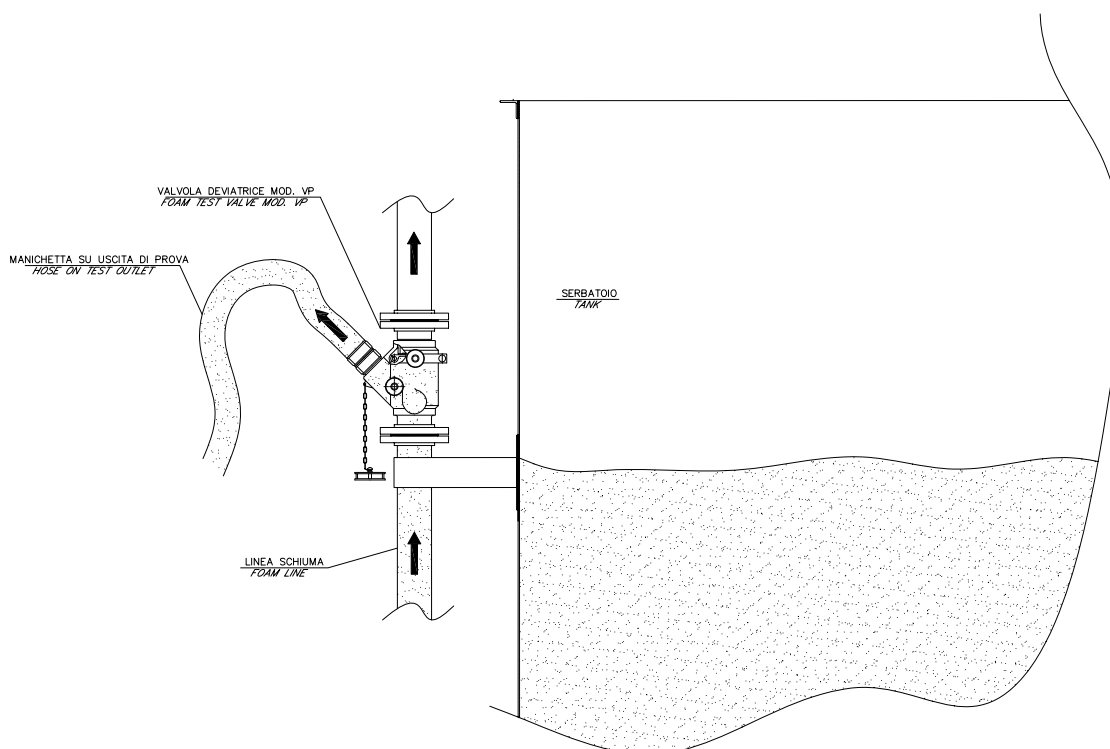

www.fasspa.net