



# MONITOR MKL

Manual monitor controlled by lever

## Standard characteristics

**Body Material:** Carbon Steel or Stainless steel

**Body Size:** 3"

**Maximum Body Flow Rate:** Max. 6000l/min

**Pressure Loss:** See diagram  $\Delta P$  Vs Flow rate

**Flow rate:** On customer Request link to compatible nozzles or branchpipes

**Flow rate recommended:** See diagram Pressure Loss Vs Flow Rate

**Recommended maximum pressure loss:** 1,2 barg

**Rotation with lever:** 360°

**Elevation and deflection with lever:** ~ +85° - 50°

**Horizontal throw:** See dedicated page on compatible nozzles or branchpipes

**Test Pressure:** 27 barg - **Custom. req.** Up to 48 barg

**Base Flange:** Carbon Steel

**Outlet Flange:** External diameter  $\varnothing 160$

**Coating:** Epoxy Primer + Polyuretanic red coat RAL3000, Total DFT >120  $\mu\text{m}$

**Weight:** for 3": ~ 30 Kg

## Approvals



## Optional

- > Pressure gauge on outlet
- > Drain Valve

## Compatible Nozzles Or Branchpipes

- > Foam and self inducing foam branchpipes mod. LS and LSA
- > Water branchpipe mod. LA
- > Jet spray nozzles mod. Mini GN - GN - Super GN
- > Jet spray self inducing nozzles mod. GNA & Super GNA

## Available on Demand

- > Base Flange: Other material
- > Outlet Flange: Other outlet connection with adapter (NH, Ghost, Storz)
- > Coating: Other painting cycles

## Key configuration

- > Application for self-oscillating

[www.fasspa.net](http://www.fasspa.net)

# MONITOR MKL

Manual monitor controlled by lever

## Layout & Overall Dimension - MKL Monitor

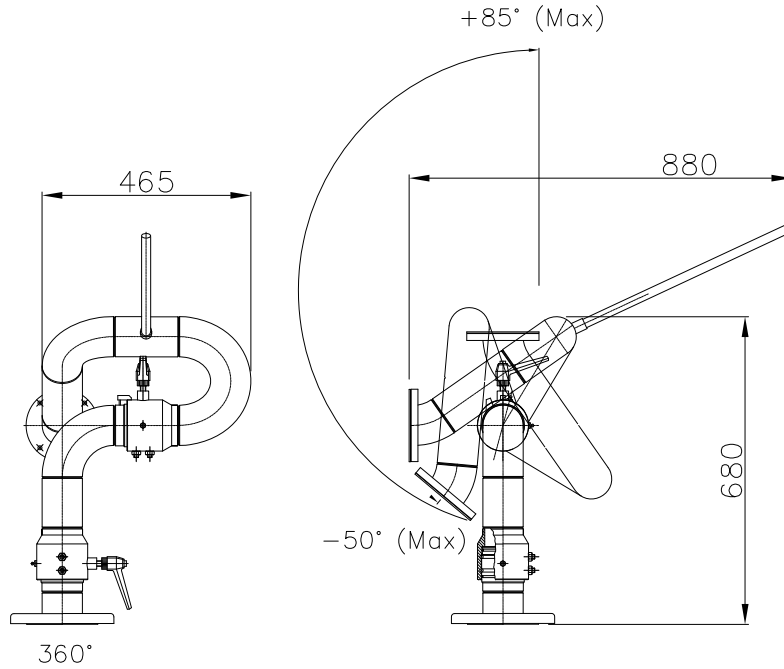

## Pressure Loss $\Delta P$ Vs Flow rate

### Monitore manuale - Manual monitor MKL

